



Brighten Dark Rooms in Your
Home with a Tubular Skylight

How It Works

The low-profile, durable acrylic dome captures sunlight from sunup through sundown. The sunlight then travels downward through a highly reflective, mirror-like tube. The light rays bounce back and forth inside the tube with 98% efficiency until the rays reach the diffuser which disperses the sunlight evenly throughout the room. What you get is natural, healthy light without the heat of incandescent bulbs or the interior color fading commonly associated with windows.



Sunlight enters the dome on roof.



Sunlight is reflected as it travels through light pipe.



Ceiling fixture softly diffuses sunlight into your home.

Key Features

- Fits all roof types – 3 mounting options
- Low profile blends into the roof line
- Impact resistant dome captures light rays even when the sun is low
- Unique condensation release design prevents moisture build-up
- Seamless commercial grade flashing is watertight and maintenance free
- Bug and dust proof sealing system
- Installs without any structural changes
- Available in 10", 13", 18" and 21" models
- Choice of Black, Bronze or Mill Finish



Pitched Roof



Flat Roof



Curb Mount

Warranty and Certifications

- Limited Lifetime Warranty – including all components!
- Qualifies for a 30% Federal Tax Credit when paired with our Solar LED Light Kit
- ICC-ES Listed
- Hurricane Tested and Rated, HVHZ Compliant
- Florida Building Code Approved



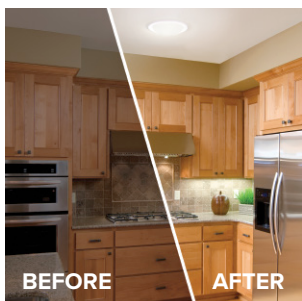

The Evolution of the Skylight

For about the cost of a nice light fixture, we can bring you the soft natural light of the sun into virtually any space in your home. Installed on most roofs in under two hours, you will quickly realize the cost benefits of a tubular skylight over traditional skylights and incandescent lighting. In addition to the free sunlight, our tubular skylights do not contribute to the heat loss or gain found with some traditional types of skylights.

Natural Light tubular skylights are precision engineered to withstand all weather conditions making them leak proof and worry free. Our models are designed to blend into the roof line and we offer a variety of interior diffusers to choose from. All components are backed by our outstanding Limited Lifetime Warranty!



Accessories...

Dimmer with Remote

The dimmer allows you to adjust the amount of daylight entering a room with an easy-to-use remote control. Perfect for any room that may need to be darkened during the day such as bedrooms, media rooms and conference rooms.



Solar LED Light Kit

Installs directly into the light pipe and features rechargeable batteries that illuminate between 8-10 hours with an auto shut-off. Homeowners are eligible for the 30% Federal Solar Tax Credit on all residential tubular skylight installations that include our Solar LED Light Kit.



Electric Light Kit

Adds an electric light fixture directly into the tubular skylight for nighttime use. It can replace a previous light fixture or extend the illumination provided by your tubular skylight on rainy days. Available in single or dual bulb versions.



Exhaust Vent Kit

Extremely quiet vent kit motor is capable of exhausting 125 cfm. Perfect for laundry rooms and bathrooms, it incorporates a sleek light fixture with a hidden intake. Available for the 10" model.



Quality Components

From the dome to the diffuser, Natural Light Tubular Skylights are engineered to be leak-proof and maintenance-free.

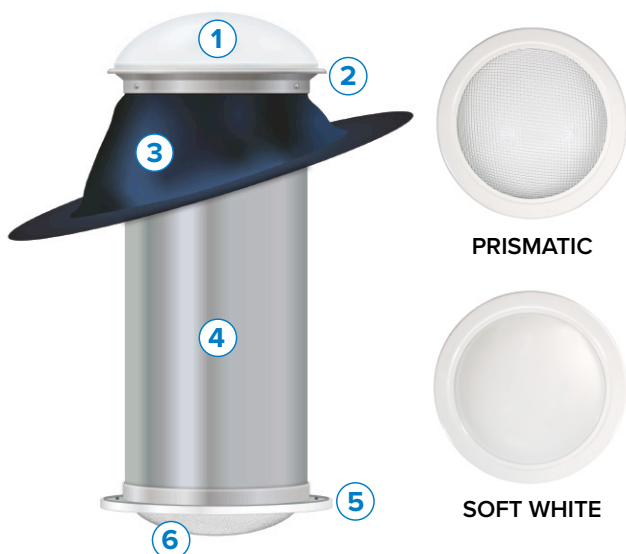

1

DOME – constructed from high impact modified acrylic. Considerably stronger than regular acrylic, easily withstands wide temperature variations. The material is UV stabilized, absorbing 99% of UV rays while maintaining optic clarity.

2

STRESS COLLAR – seamless aluminum, factory fastened to the dome to prevent leaking. Functions to equalize the stress around it, preventing cracking.

3

FLASHING – .080 seamless aluminum, making it one of the thickest flashings on the market. Designed to uniformly expand and contract under changing environmental conditions making it leak proof and worry-free.

4

LIGHT PIPE – silver coated aluminum with a total reflectivity of 98% that outperforms other light pipes particularly during early morning and late afternoon when light is needed the most.

5

TRIM RING – seamless aluminum, powder coated white for durability, blends into any decor.

6

DIFFUSER – designed with a precise arc for exact light dispersion without spot lighting or glare. Available in prismatic or soft white, flat or domed.



4 Kit Sizes Available

Model Size	Coverage Area	Wattage Equivalent	Max Tube Length
10"	up to 150 sq. ft.	up to 300 watts	18'
13"	up to 300 sq. ft.	up to 500 watts	20'
18"	up to 500 sq. ft.	up to 1,000 watts	20'
21"	up to 700 sq. ft.	up to 1,450 watts	20'

Kits include 4 feet of light pipe. Extra sections of light pipe and angle adapters available for all models.

Models for All Roof Types

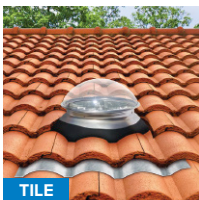

TILE



FOAM



ASPHALT



ROLLED



RUBBER



METAL



Natural Light[™]
ENERGY SYSTEMS

www.nltubular.com

